

Radio technology RTW

NEW ETR3 59: Finecorsa radio / Radio end limit switch

**Facile regolazione
dei finecorsa
dal telecomando**

*Easy end limits adjustment
by the transmitter*

**Facile impostazione
dei comandi di gruppo**

*Easy group controls
adjustment*

**Facile inversione del
senso di rotazione
dal telecomando**

*Easy inversion of the
sense of rotation
by the transmitter*

**Minimo cablaggio
(comandi solo via radio)**

*Minimal wiring
(only radio remote controls)*

Ø59 ETR3

Motore tubolare Ø59 con 3 finecorsa
idoneo per applicazioni su tende da sole e tapparelle di dimensioni e peso elevati.
Tubular motor Ø59 with 3 end limit switches
suitable for awnings and rolling shutters with heavy weight and large size dimensions.

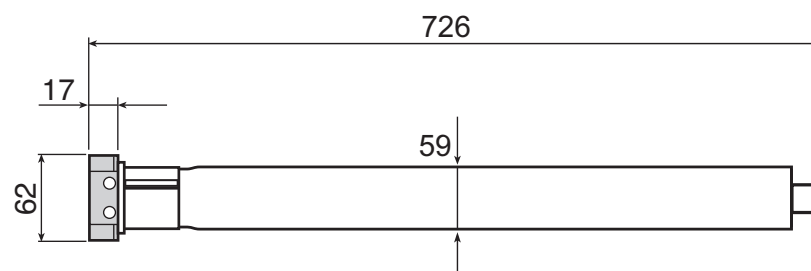

Caratteristiche tecniche / Technical features

CODICE CODE	DESCRIZIONE DESCRIPTION	COPPIA TORQUE	VELOCITÀ SPEED	GIRI FC LS ROUNDS	ASSORBIMENTO CONSUMPTION	ALIMENTAZIONE POWER SUPPLY	GRADO DI PROT. PROT. DEGREE	LUNGHEZZA LENGTH	PESO MOTORE MOTOR WEIGHT	IMBALLO PACKAGE	CERTIFICAZIONE CERTIFICATION
2252130	ETR3 80-12	80 Nm	12 Rpm	infiniti/infinite	380 W	230 V ~ / 50 Hz	IP 44	726 mm	5,38 Kg	1 pz/pc	CE
2253128	ETR3 100-12	100 Nm	12 Rpm	infiniti/infinite	485 W	230 V ~ / 50 Hz	IP 44	726 mm	5,60 Kg	1 pz/pc	CE
2254116	ETR3 120-8	120 Nm	8 Rpm	infiniti/infinite	350 W	230 V ~ / 50 Hz	IP 44	726 mm	5,81 Kg	1 pz/pc	CE

Lunghezza cavo 2,5 m - 3 conduttori / Cable length 2,5 m - 3 wires

Radio technology RTW

NEW ETR3 59: Finecorsa radio / Radio end limit switch

Applicazione Application

Tende da sole
Awnings



Dati prestazionali / Performance data

CODICE CODE	DESCRIZIONE DESCRIPTION	COPPIA TORQUE	VELOCITÀ SPEED	MOTORE MOTOR	TUBO TONDO ROUND TUBE	2 BRACCIA 2 ARMS	4 BRACCIA 4 ARMS	6 BRACCIA 6 ARMS
						SPORGENZA PROJECTION	SPORGENZA PROJECTION	SPORGENZA PROJECTION
2252130	ETR3 80-12	80 Nm	12 Rpm	Ø 59	Ø 78	3,5 m - 4 m	3 m - 3,5 m	2 m - 2,5 m
2253128	ETR3 100-12	100 Nm	12 Rpm	Ø 59	Ø 78	4,5 m	4 m	3 m - 3,5 m - 4 m
2254116	ETR3 120-8	120 Nm	8 Rpm	Ø 59	Ø 78	/	4,5 m	4,5 m

Applicazione Application

Tapparelle
Rolling shutters



CODICE CODE	DESCRIZIONE DESCRIPTION	COPPIA TORQUE	VELOCITÀ SPEED	MOTORE MOTOR	TUBO OTT. OCTO TUBE	PESO SOLLEVATO LIFTED WEIGHT
2252130	ETR3 80-12	80 Nm	12 Rpm	Ø 59	Ø 70	81 - 90 Kg
2253128	ETR3 100-12	100 Nm	12 Rpm	Ø 59	Ø 70	91 - 115 Kg
2254116	ETR3 120-8	120 Nm	8 Rpm	Ø 59	Ø 70	116 - 140 Kg

Facile impostazione
dei finecorsa
dal telecomando
Easy end limits adjustment
by the transmitter

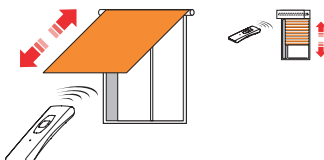

Minimo cablaggio
(comandi solo via radio)
Minimal wiring
(only radio remote controls)

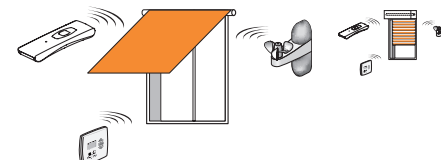

Adatto per applicazioni
a destra e a sinistra
Suitable for left and
right application

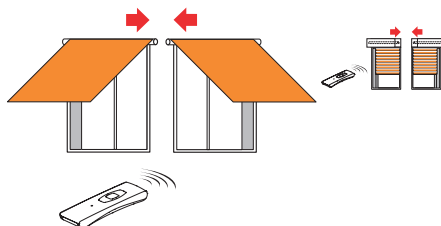

Facile inversione
del senso di rotazione
dal telecomando
Easy inversion of the
sense of rotation
by the transmitter

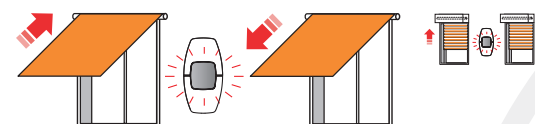

Facile impostazione dei
comandi di gruppo
Easy group controls
adjustment

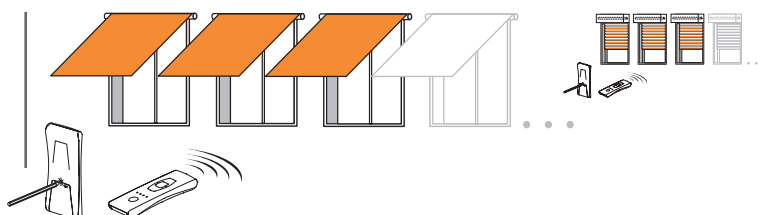

Accessori Accessories

Staffe Brackets

p.76



Adattatori Adapters

p.82



Meccanici Mechanicals

p.85



Controlli radio Remote controls

p.16



Download
Selezionare 1 codice
QR alla volta
Select 1 single QR
code each time

Guida programmazione Programming guide



Manuale d'uso Instruction manual



Dichiarazione di conformità Conformity declaration



Motori tubolari Tubular motors

ETR3 59 - ETR-A 59 - CD 59

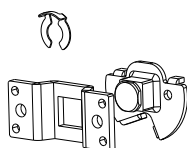

2205025



Staffa con perno quadrato
Bracket with square pin

CONF. 5 PZ / PACK. 5 PCS

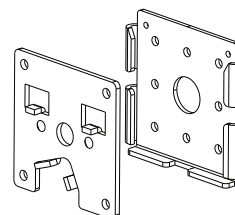

2205027



**Staffa scorrevole
interasse 48 box**
*Sliding bracket
center to center 48 box*

CONF. 5 PZ / PACK. 5 PCS

Motori tubolari Tubular motors

CDE 59 con manovra di soccorso / *with manual override*

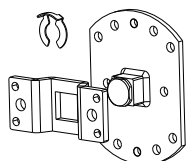

2200160



**Staffa orientabile con perno quadrato
a due posizioni e relativa sella**
Revolving bracket with two positions square pivot

CONF. 5 PZ / PACK. 5 PCS

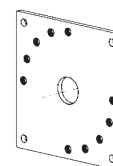

2200043



Staffa 100 x 100
100 x 100 bracket plate

CONF. 5 PZ / PACK. 5 PCS

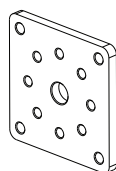

2200161



Staffa quadrata interasse 48 box
Square bracket 48 center to center box

CONF. 5 PZ / PACK. 5 PCS

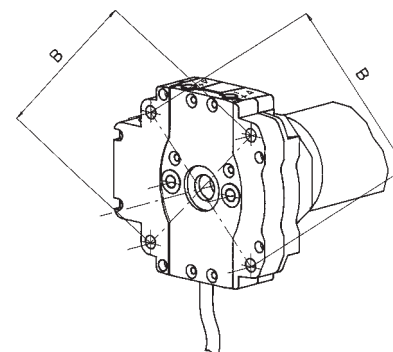

**Interasse B: da utilizzare tassativamente
per i motori con coppia $\geq 80\text{Nm}$.**
*Interax distance B: to fix motors with nominal
torque $\geq 80\text{Nm}$.*

Motori tubolari
Tubular motors

ETR3 59 - ETR-A 59 - CD 59 - CDE 59



Ø70 x 1,5 mm Corona e ruota / Crown and wheel

2205024

**Adattatori per tubo ottagonale
Metallo**
*Adapters for octagonal rolling tube
Metal*

CONF. 5 PZ / PACK. 5 PCS



Ø102 x 2 mm Corona e ruota / Crown and wheel

2200155

**Adattatori per tubo rotondo
Metallo**
*Adapters for round rolling tube
Metal*

CONF. 5 PZ / PACK. 5 PCS



Ø70 x 1,5 mm Corona e ruota / Crown and wheel

2200159

**Adattatori per tubo rotondo
Metallo**
*Adapters for round rolling tube
Metal*

CONF. 5 PZ / PACK. 5 PCS



LP Ø89 x 1 mm Corona e ruota / Crown and wheel

2200158

**Adattatori per tubo deprat - F5039
Metallo**
*Adapters for deprat rolling tube - F5039
Metal*

CONF. 5 PZ / PACK. 5 PCS



Ø85 x 1,5 mm Corona e ruota / Crown and wheel

2200156

**Adattatori per tubo rotondo
con ogiva tonda - Metallo**
*Adapters for round
with groove rolling tube - Metal*

CONF. 5 PZ / PACK. 5 PCS



Ø80 x 1/1,2 mm Corona e ruota / Crown and wheel

2200157

**Adattatori per tubo ZF80
Metallo**
*Adapters for ZF80 rolling tube
Metal*

CONF. 5 PZ / PACK. 5 PCS



Ø78 x 1,5 mm Corona e ruota / Crown and wheel

2205026

**Adattatori per tubo rotondo
con ogiva tonda 14 mm - Metallo**
*Adapters for round with 14 mm groove
rolling tube - Metal*

CONF. 5 PZ / PACK. 5 PCS



Motori tubolari
Tubular motors

ETR3 59 - CD 59 - CDE 59

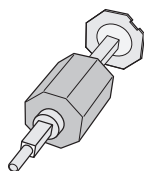

2200026

**Fondello in materiale plastico con
perno tondo per tubo ottagonale Ø 70**
*Adjustable plastic cap with pivot for
Ø 70 octagonal rolling tube*

CONF. 1 PZ / PACK. 1 PCS

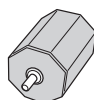

2200024

**Fondello in materiale plastico
con perno tondo per
tubo ottagonale Ø 70**
*Plastic cap with pivot for Ø 70
octagonal rolling tube*

CONF. 1 PZ / PACK. 1 PC

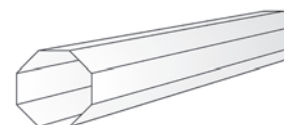

2200017

Barra 3m tubo ottagonale Ø 70
3 m Ø 70 octagonal tube

CONF. 4 PZ / PACK. 4 PCS