

Coppie elevate
High torques
Facile da installare
Easy to install

Ø59 CD 59

Motore tubolare Ø59 con finecorsa meccanico filare
idoneo per applicazioni su tende da sole e tapparelle di dimensioni e peso elevati.
Tubular motor Ø59 with mechanical end limit switch
suitable for awnings and rolling shutters with heavy weight and large size dimensions.

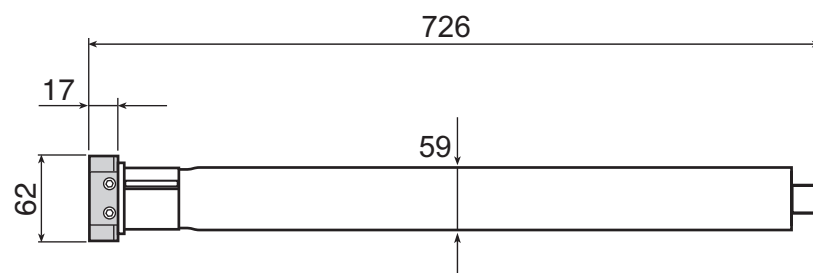

Caratteristiche tecniche / *Technical features*

CODICE CODE	DESCRIZIONE DESCRIPTION	COPPIA TORQUE	VELOCITÀ SPEED	GIRI FC LS ROUNDS	ASSORBIMENTO CONSUMPTION	ALIMENTAZIONE POWER SUPPLY	GRADO DI PROT. PROT. DEGREE	LUNGHEZZA LENGTH	PESO MOTORE MOTOR WEIGHT	IMBALLO PACKAGE	CERTIFICAZIONE CERTIFICATION
2252095	CD 80-12	80 Nm	12 Rpm	23	380 W	230 V ~ / 50 Hz	IP 44	726 mm	5,30 Kg	1 pz/pc	CE
2253103	CD 100-12	100 Nm	12 Rpm	23	485 W	230 V ~ / 50 Hz	IP 44	726 mm	5,52 Kg	1 pz/pc	CE
2254086	CD 120-8	120 Nm	8 Rpm	23	350 W	230 V ~ / 50 Hz	IP 44	726 mm	5,73 Kg	1 pz/pc	CE

Lunghezza cavo 2,5 m - 4 conduttori / *Cable length 2,5 m - 4 wires*

Applicazione Application

Tende da sole
Awnings



Dati prestazionali / Performance data

CODICE CODE	DESCRIZIONE DESCRIPTION	COPPIA TORQUE	VELOCITÀ SPEED	MOTORE MOTOR	TUBO TONDO ROUND TUBE	2 BRACCIA 2 ARMS	4 BRACCIA 4 ARMS	6 BRACCIA 6 ARMS
						SPORGENZA PROJECTION	SPORGENZA PROJECTION	SPORGENZA PROJECTION
2252095	CD 80-12	80 Nm	12 Rpm	Ø 59	Ø 78	3,5 m - 4 m	3 m - 3,5 m	2 m - 2,5 m
2253103	CD 100-12	100 Nm	12 Rpm	Ø 59	Ø 78	4,5 m	4 m	3 m - 3,5 m - 4 m
2254086	CD 120-8	120 Nm	8 Rpm	Ø 59	Ø 78	/	4,5 m	4,5 m

Applicazione Application

Tapparelle
Rolling shutters



Dati prestazionali / Performance data

CODICE CODE	DESCRIZIONE DESCRIPTION	COPPIA TORQUE	VELOCITÀ SPEED	MOTORE MOTOR	TUBO OTT. OCTO TUBE	PESO SOLLEVATO LIFTED WEIGHT
2252095	CD 80-12	80 Nm	12 Rpm	Ø 59	Ø 70	81 - 90 Kg
2253103	CD 100-12	100 Nm	12 Rpm	Ø 59	Ø 70	91 - 115 Kg
2254086	CD 120-8	120 Nm	8 Rpm	Ø 59	Ø 70	116 - 140 Kg

Accessori Accessories

Staffe Brackets

p.76



Adattatori Adapters

p.82



Meccanici Mechanicals

p.85



Controlli Controls

p.67



Download

Selezionare 1 codice
QR alla volta
Select 1 single QR
code each time

Manuale d'uso Instruction manual



Dichiarazione di conformità Conformity declaration



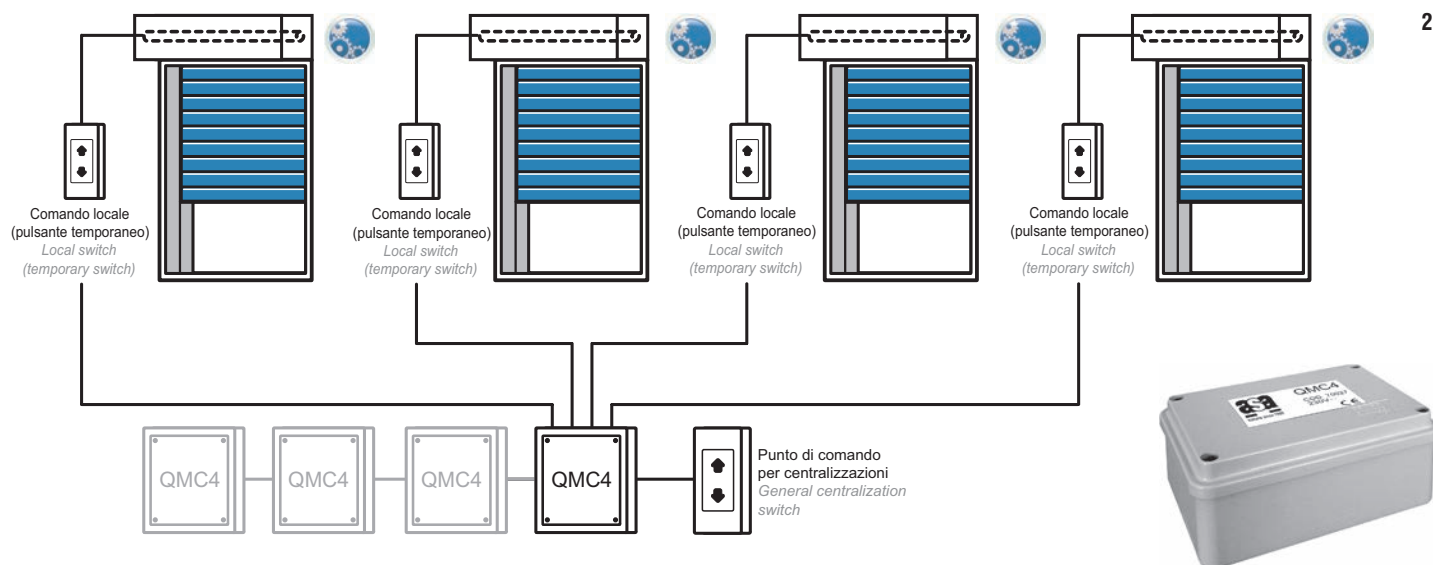

2212004

QMC4

Centrale di controllo per il collegamento in parallelo di motori meccanici filari (max 4 motori per centrale).
Control unit for mechanical wired motors connected in parallel (max 4 motors for each control unit).

CONF. 1 PZ / PACK. 1 PC



2211016

Go-er

Ricevente esterna per il controllo via radio di motori filari (1 motore per ricevente).
Compatible with all ASA radio controls.
External receiver for radio control of wired motors (1 motor for each receiver).
Compatible with all ASA radio controls.

CONF. 1 PZ / PACK. 1 PC



2211149

Go-er platine

Ricevente esterna per il controllo via radio di motori filari, specifica per applicazioni su cassonetto (1 motore per ricevente).
Compatible with all ASA radio controls.
External receiver for radio control of wired motors specific for cassette application (1 motor for each receiver).
Compatible with all ASA radio controls.

CONF. 1 PZ / PACK. 1 PC

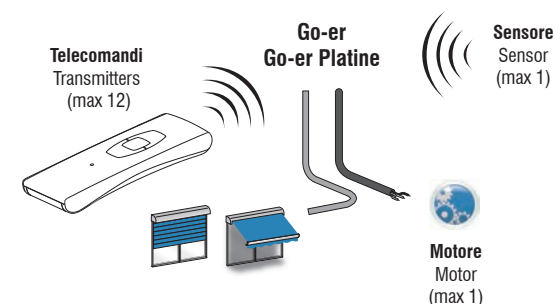

Motori tubolari
Tubular motors

ETR 59 - ETR-A 59 - CD 59

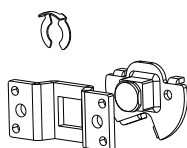

2205025



Staffa con perno quadrato
Bracket with square pin

CONF. 5 PZ / PACK. 5 PCS

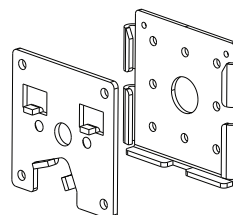

2205027



Staffa scorrevole
interasse 48 box
Sliding bracket
center to center 48 box

CONF. 5 PZ / PACK. 5 PCS

Motori tubolari
Tubular motors

CDE 59 con manovra di soccorso / with manual override

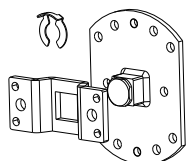

2200160



Staffa orientabile con perno quadrato
a due posizioni e relativa sella
Revolving bracket with two positions square pivot

CONF. 5 PZ / PACK. 5 PCS

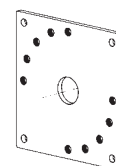

2200043



Staffa 100 x 100
100 x 100 bracket plate

CONF. 5 PZ / PACK. 5 PCS

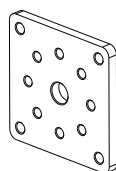

2200161



Staffa quadrata interasse 48 box
Square bracket 48 center to center box

CONF. 5 PZ / PACK. 5 PCS

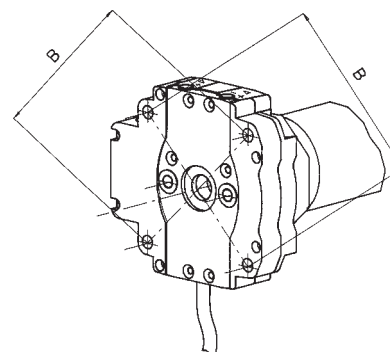

Interasse B: da utilizzare tassativamente
per i motori con coppia $\geq 80\text{Nm}$.
Interax distance B: to fix motors with nominal
torque $\geq 80\text{Nm}$.



Motori tubolari
Tubular motors

ETR 59 - ETR-A 59 - CD 59 - CDE 59



Ø70 x 1,5 mm Corona e ruota / Crown and wheel

2205024

Adattatori per tubo ottagonale
Metallo
Adapters for octagonal rolling tube
Metal

CONF. 5 PZ / PACK. 5 PCS

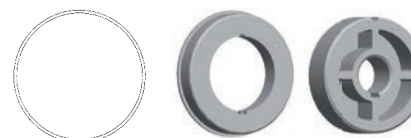

Ø102 x 2 mm Corona e ruota / Crown and wheel

2200155

Adattatori per tubo rotondo
Metallo
Adapters for round rolling tube
Metal

CONF. 5 PZ / PACK. 5 PCS



Ø70 x 1,5 mm Corona e ruota / Crown and wheel

2200159

Adattatori per tubo rotondo
Metallo
Adapters for round rolling tube
Metal

CONF. 5 PZ / PACK. 5 PCS



LP Ø89 x 1 mm Corona e ruota / Crown and wheel

2200158

Adattatori per tubo deprat - F5039
Metallo
Adapters for deprat rolling tube - F5039
Metal

CONF. 5 PZ / PACK. 5 PCS



Ø85 x 1,5 mm Corona e ruota / Crown and wheel

2200156

Adattatori per tubo rotondo
con ogiva tonda - Metallo
Adapters for round
with groove rolling tube - Metal

CONF. 5 PZ / PACK. 5 PCS



Ø80 x 1/1,2 mm Corona e ruota / Crown and wheel

2200157

Adattatori per tubo ZF80
Metallo
Adapters for ZF80 rolling tube
Metal

CONF. 5 PZ / PACK. 5 PCS



Ø78 x 1,5 mm Corona e ruota / Crown and wheel

2205026

Adattatori per tubo rotondo
con ogiva tonda 14 mm - Metallo
Adapters for round with 14 mm groove
rolling tube - Metal

CONF. 5 PZ / PACK. 5 PCS



Motori tubolari
Tubular motors

ETR 59 - CD 59 - CDE 59

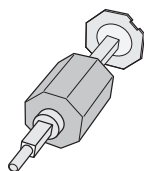

2200026

**Fondello in materiale plastico con
perno tondo per tubo ottagonale Ø 70**
*Adjustable plastic cap with pivot for
Ø 70 octagonal rolling tube*

CONF. 1 PZ / PACK. 1 PCS

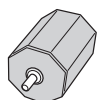

2200024

**Fondello in materiale plastico
con perno tondo per
tubo ottagonale Ø 70**
*Plastic cap with pivot for Ø 70
octagonal rolling tube*

CONF. 1 PZ / PACK. 1 PC

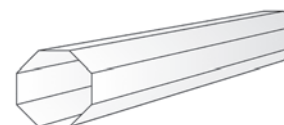

2200017

Barra 3m tubo ottagonale Ø 70
3 m Ø 70 octagonal tube

CONF. 4 PZ / PACK. 4 PCS

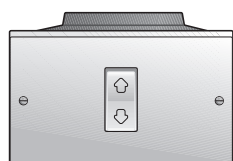

2210003 Pulsantiera temporanea (incasso)
Temporary position switch (wall mounted)

CONF. 1 PZ / PACK. 1 PC



2210011 Pulsantiera in box stagno temporanea (parete)
Waterproof momentary position switch (surface mounted)

CONF. 1 PZ / PACK. 1 PC



2210004 Pulsantiera temporanea (parete)
Temporary position switch (surface mounted)

CONF. 1 PZ / PACK. 1 PC



2210012 Mini pulsantiera temporanea (parete)
Temporary position mini switch (surface mounted)

CONF. 1 PZ / PACK. 1 PC



2210007 Pulsante stabile
Fixed position switch

CONF. 1 PZ / PACK. 1 PC



2210013 Mini pulsantiera stabile (parete)
Fixed position mini switch (surface mounted)

CONF. 1 PZ / PACK. 1 PC



2210008 Pulsante temporaneo
Temporary position switch

CONF. 1 PZ / PACK. 1 PC