

Attuatore elettrico lineare MINGARDI con movimento a stelo rigido ad alta resistenza ai carichi di punta. Funzionamento con tensione di alimentazione 230V~ 50 Hz. Conforme alle Direttive 2006/95 LVD - 2004/108 EMC. Dotato di microinterruttori di fine corsa e relè per il collegamento in parallelo. Protezione termica incorporata. Colore disponibile: anodizzato argento. Completo di accessori di fissaggio.

MINGARDI linear actuator with rigid rod movement and high resistance to maximum loads. Operation 230V~ 50 Hz power supply.

It complies with 2006/95 LVD - 2004/108 EMC directives.

Fitted with limit switches and relays for connection in parallel. Incorporated thermal overload protection.

Available colours: anodised silver. Complete with fixing accessories.

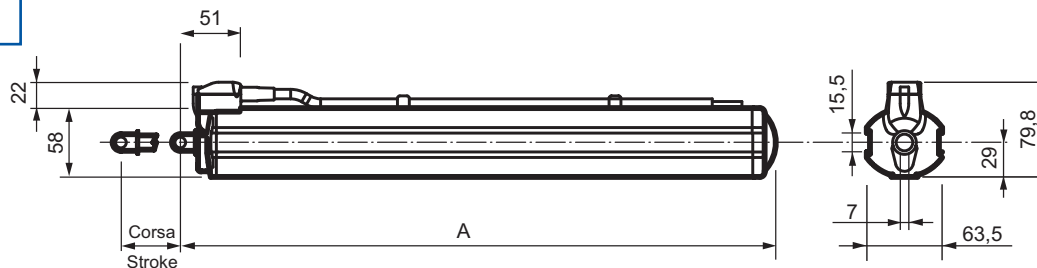

| Corsa/Stroke | A |
|--------------|-------|
| 200 | 318,8 |
| 300 | 418,8 |
| 400 | 518,8 |

Technical drawing of a shaft assembly. The shaft is labeled M8. Dimensions are indicated: 10, 62, and 10. The drawing shows a shaft with two flanges and a central section with a different diameter.

2700102

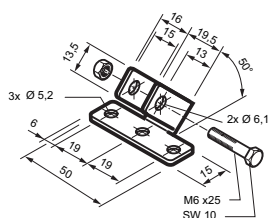

2700064

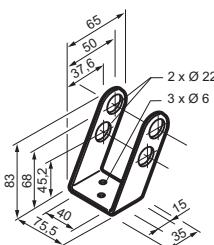

2700124

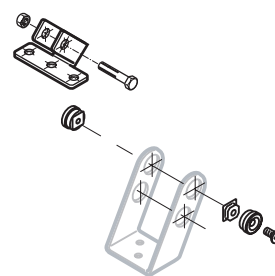

2700107

| CODICE CODE | DESCRIZIONE DESCRIPTION |
|----------------|----------------------------|
|----------------|----------------------------|

| CODICE CODE | DESCRIZIONE DESCRIPTION |
|----------------|----------------------------|
|----------------|----------------------------|

2700124 Staffa supporto motore
Motor support bracket

2700107 2700064 + accessori per staffa 2700124 (esclusa)
2700064 + accessories for bracket 2700124 (not included)

ACCESSORI DI COMANDO: per informazioni si prega di contattare il nostro servizio tecnico-commerciale
CONTROL ACCESSORIES: please contact our technical support service for further information